



---

*MANUFACTURING HIGH QUALITY  
ENVIRONMENTAL ABATEMENT EQUIPMENT  
SINCE 1988*

---



# **PEROx PG**

## **Operations and Maintenance Manual**



## WARNING



**This equipment to be operated only by trained personnel.  
Do not use with combustible or explosive material.  
Do not expose to water or rain.  
Connect only to grounded outlet with GFCI device.  
Disconnect power for cleaning and servicing.  
High intensity Ultraviolet light. Avoid eye and skin exposure.  
Do not operate without coverings. Do not look directly at UV light source.  
Wear UV eye protection.**



### **Safety Warning Instructions:** **Read and save these instructions**

- This equipment to be operated only by trained personnel.
- Do not use with combustible or explosive material.
- Do not expose to water or rain.
- Connect only to grounded outlet with GFCI device.
- Disconnect power for cleaning and servicing.
- Do not operate if cord or plug is damaged. Contact a authorized service facility for examination and/or repair.
- Do not run cord under carpeting. Do not cover cord with throw rugs, runners, or similar coverings. Arrange cord away from traffic areas and where it is not a tripping hazard.
- Disconnect power for cleaning and servicing.
- High intensity Ultraviolet light inside. Avoid eye and skin exposure.
- Do not look directly at UV light source. Wear UV eye protection.
- Do not operate without coverings.

### **Avertissement de sécurité Instructions:** **LIRE ET CONSERVER CES INSTRUCTIONS**

- Cet équipement doit être utilisé que par un personnel formé.
- Ne pas utiliser avec des matières combustibles ou explosives.
- Ne pas exposer à l'eau ou à la pluie.
- Connectez uniquement à une prise mise à la terre avec un dispositif GFCI.
- Coupez l'alimentation électrique pour le nettoyage et l'entretien.
- Ne pas utiliser si le cordon ou la fiche est endommagé. Contactez un centre de service autorisé pour examen et / ou réparation.
- Ne pas passer le cordon sous un tapis. Ne pas couvrir le cordon avec des carpettes, les coureurs, ou revêtements similaires. Éloigner le cordon des endroits passants et où il n'est pas un risque de déclenchement.
- Coupez l'alimentation électrique pour le nettoyage et l'entretien.
- Haute intensité de lumière ultraviolette à l'intérieur. Évitez les yeux et l'exposition de la peau.
- Ne pas regarder directement à la source de lumière UV. Porter des lunettes de protection UV.
- Ne pas faire fonctionner sans revêtement.

# PERO<sub>x</sub> PG

## SPECIFICATIONS:

- **Controls:** ON-OFF-TIMER Switch, Hour Meter, 0-12 hr timer
- **Airflow:** 100 - 2000 CFM from external fan
- **Pre-filter:** 2" Pleated Filter, MERV-11 efficiency, 12"x12"x2"
- **Housing:** Mill Finish Aluminum
- **Weight with Filters:** 16 lbs.
- **Dimensions:** 12"L x 16"W x 27"H
- **Operating conditions:** Non-hazardous environment, 104° F maximum temperature
- **Power requirements:** 115 Vac/60 Hz/3.0 Amps

## ORDERING INFO..... PART #

OmniAire PERO <sub>x</sub> PG .....	OAHPG
Primary/Secondary Filter .....	OPF1212
Quick Clamp, 14" .....	QCW14
Flexible Duct, 12"x25' .....	OAD12
<b>PERO<sub>x</sub> replacement cell, 14"</b> .....	<b>EHPG-4</b>



*Independent studies by labs and universities confirm the following results of effectiveness of Ionized-Hydro-Peroxide purifiers:*

- **99.99% surface bacteria/virus reduction**
- **Over 80% VOC reduction**
- **97% airborne bacterial reduction**
- **85% odor reduction**
- **97% airborne mold reduction**
- **US Military approved for mold protection in field hospitals**
- **Hospital approvals Infectious Diseases - U.S. and International**
- **99% reduction of Staph (MRSA)**
- **Tested and approved by the Chinese Government for protection against the SARS virus**
- **Approved by the USDA, FSIS and FDA for use in food processing plants**

## **RECEIVING INSTRUCTIONS:**

**Unpacking:** Visually inspect the unit for damage. Ensure that the pleated filters have not been dislodged during shipping. The pleated filter should be covering the entire opening on both sides of the unit.

If the filter is not seated correctly then remove the bottom plate of the unit, reposition the filter, and reinstall the bottom plate before operation to ensure that there is no bypass around the filter. This unit must be operated with the filters in place to prevent any UV radiation outside the unit.

## **OPERATION OF PERO<sub>x</sub> PG:**

The **PERO<sub>x</sub> PG** requires external air supply to disperse generated oxidizer plasma to purify surrounding air and surfaces. The oxidizer plasma, generated from O<sub>2</sub> and humidity in the air, remains active for about 15 minutes, then it returns to O<sub>2</sub> and humidity. The airflow through the PERO<sub>x</sub> unit should be 100 to 2,000 CFM to operate properly. The airflow thru **PERO<sub>x</sub>** is unidirectional so it does not matter which side is used as the intake. **THE PERO<sub>x</sub> UNIT MUST OPERATE WITH PLEATED FILTERS INSTALLED. THE PERO<sub>x</sub> OXIDIZER PLASMA IS SAFE FOR HUMAN EXPOSURE, BUT INDIVIDUAL COMFORT LEVELS VARY.**

## **OPERATING INSTRUCTIONS:**

1. When using **PERO<sub>x</sub> PG** with an **OmniAire** HEPA unit, it should be aligned with or connected to the exhaust of the machine to maximize the air purification process. When **PERO<sub>x</sub> PG** is used with an air mover without internal filter, the **PERO<sub>x</sub>** should be aligned with intake or outlet side of air mover.
2. Turn the air machine On prior to turning on the **PERO<sub>x</sub>** unit.
3. Switch **PERO<sub>x</sub>** rocker switch to **ON** position for continuous operation or to **TIMER** for up to 12 hours of operation. Set the desired number of hours on the **TIMER** switch. The hour meter will measure the generator's running time. Leave the air machine on for a minimum 2 minutes after shutting the **PERO<sub>x</sub>** unit off to ensure that all residual plasma is exhausted.

## **REPLACEMENT OF THE PREFILTER:**

1. Unplug the unit and remove the bottom panel.
2. The filters are held in place by a spring clip that is permanently attached to the unit. Push down on the filter itself until it clears the clamp the remove it.
3. To re-install the filter place the bottom edge of the filter inside the clip and then push down on the filter itself until it snaps into place.

## **REPLACEMENT OF HYDRO-PEROXIDE GENERATOR CELL:**

The generator cell's output slowly degrades and should be replaced after 25,000 hours of running. To replace the cell, remove the control panel and four screws holding the generator. Unplug the power supply connector and remove the whole generator from the unit. Then just follow the instructions included with the replacement cell.

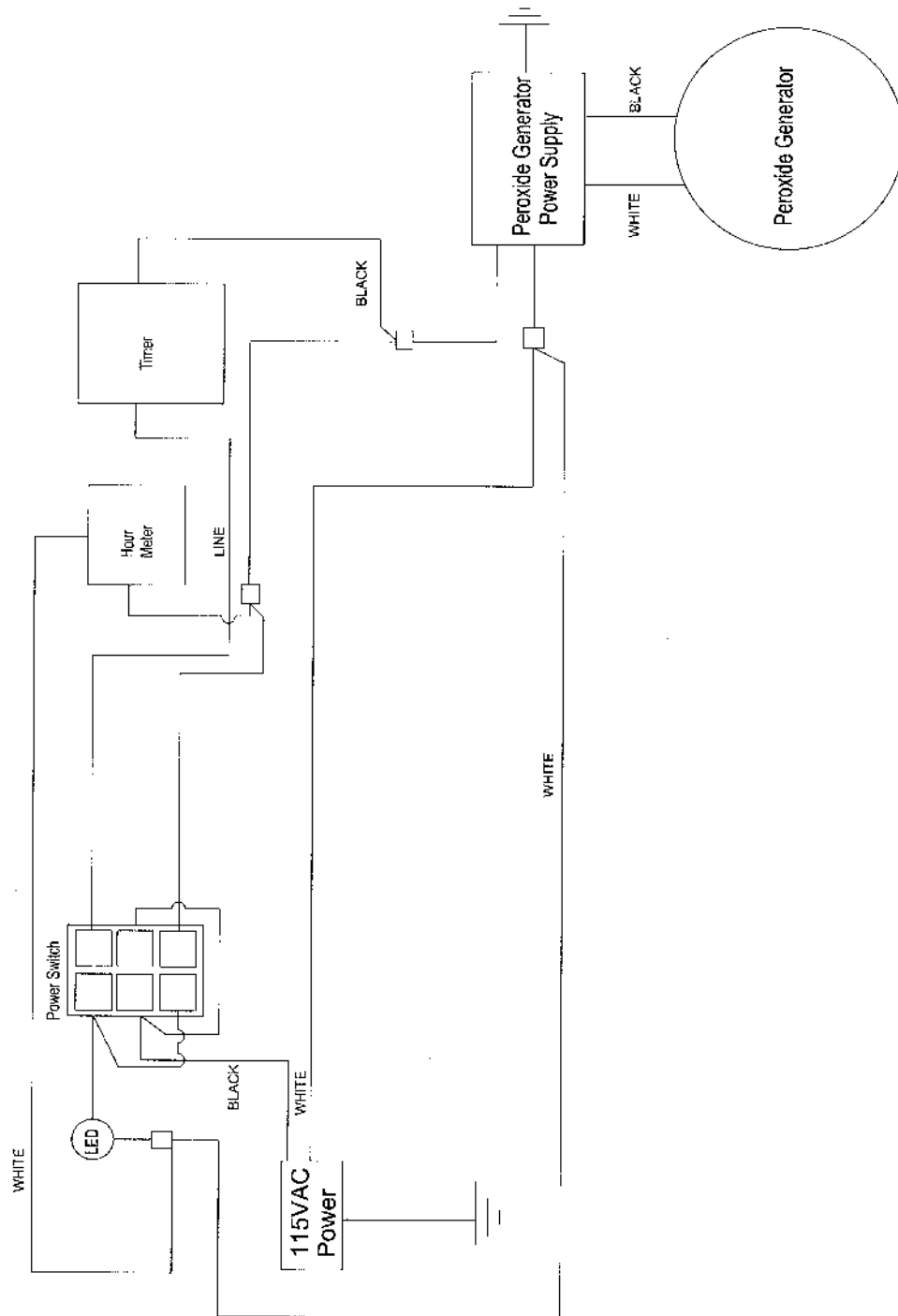



---

*MANUFACTURING HIGH QUALITY  
ENVIRONMENTAL ABATEMENT EQUIPMENT  
SINCE 1988*

---

**Omnitec Design, Inc.**

4640 Campus Place, Suite 110 Mukilteo, WA 98275

Visit us @ [www.omnitecdesign.com](http://www.omnitecdesign.com)

Office: 425-290-3922